

Danube, Rhine, Main & Moselle deck plans

Emerald Dawn & Emerald Sun

• Built: 2015 • Length: 443ft (135m) • Guests: 180 • Cabins: 91 • Crew Members: 51

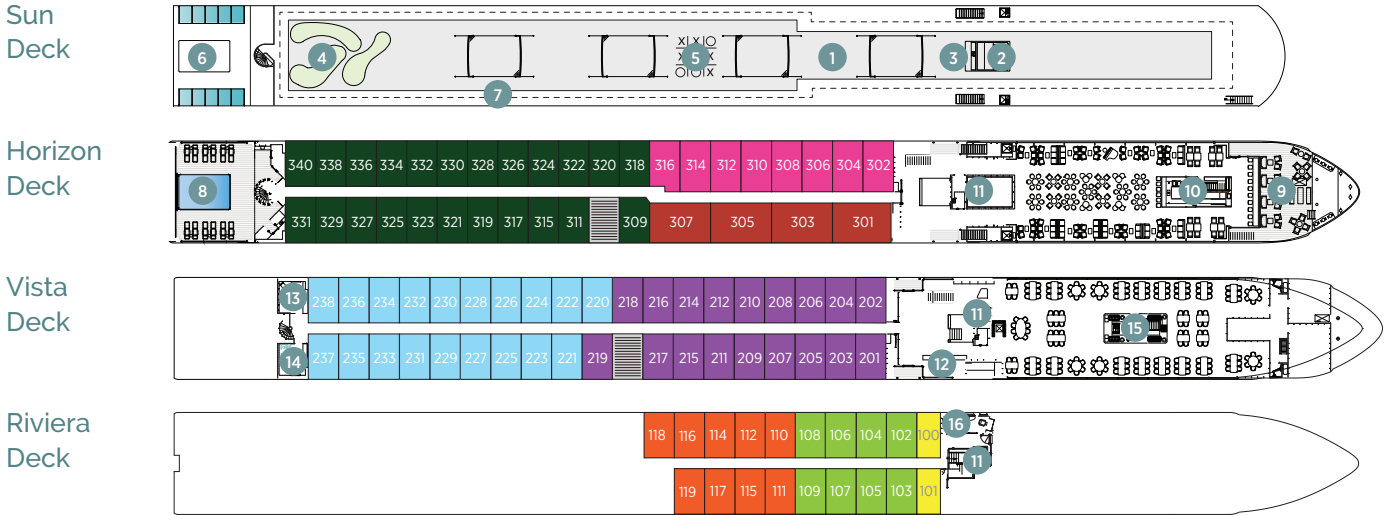
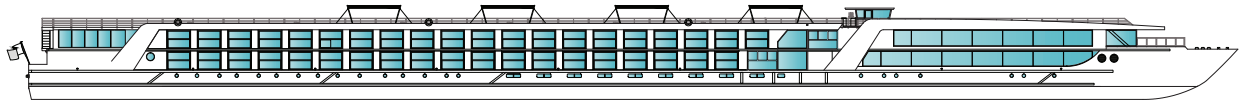

Cabin Categories		
Horizon Deck		Size ft ² (m ²)
CAT SA	Owner's One-Bedroom Suite	315ft ² (29.3m ²)
CAT S	Grand Balcony Suite*	210ft ² (19.5m ²)
CAT A	Emerald Panorama Balcony Suite	180ft ² (16.7m ²)
Vista Deck		Size ft ² (m ²)
CAT B	Emerald Panorama Balcony Suite	180ft ² (16.7m ²)
CAT C	Emerald Panorama Balcony Suite	180ft ² (16.7m ²)
Riviera Deck		Size ft ² (m ²)
CAT D	Emerald Stateroom	162ft ² (15m ²)
CAT E	Emerald Stateroom	162ft ² (15m ²)
CAT ES	Emerald Single Stateroom	117ft ² (10.9m ²)

- 1 Sun Deck with Deck Chairs[^]
- 2 Navigation Bridge
- 3 Sky Barbecue
- 4 Golf Putting Green
- 5 Games Area
- 6 Retractable Glass Roof
- 7 Walking Track
- 8 Daytime Pool & Bar/Evening Cinema
- 9 The Terrace
- 10 Horizon Bar & Lounge
- 11 Lift
- 12 Reception
- 13 Wellness Area
- 14 Fitness Area
- 15 Reflections Restaurant
- 16 Hairdresser

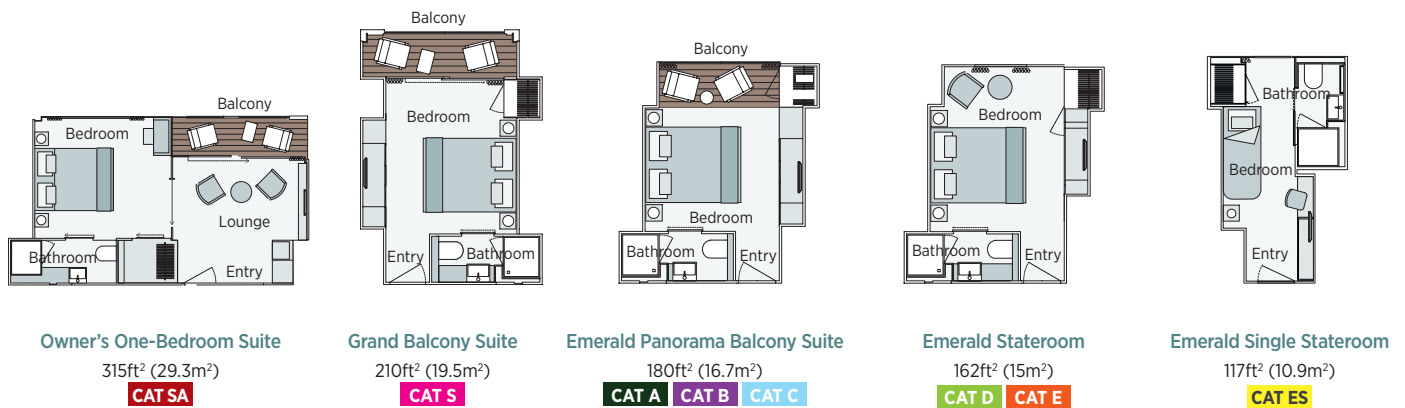

Important Information: The cabin and deck plans, sizes and photographs are an indication only and are subject to variation.

[^] Due to safety, the Sun Deck will be closed when travelling under low bridges.

* Cabin 316 has a slightly varied layout.